

NEW CONSTRUCTION PLAN - FIRST FLOOR

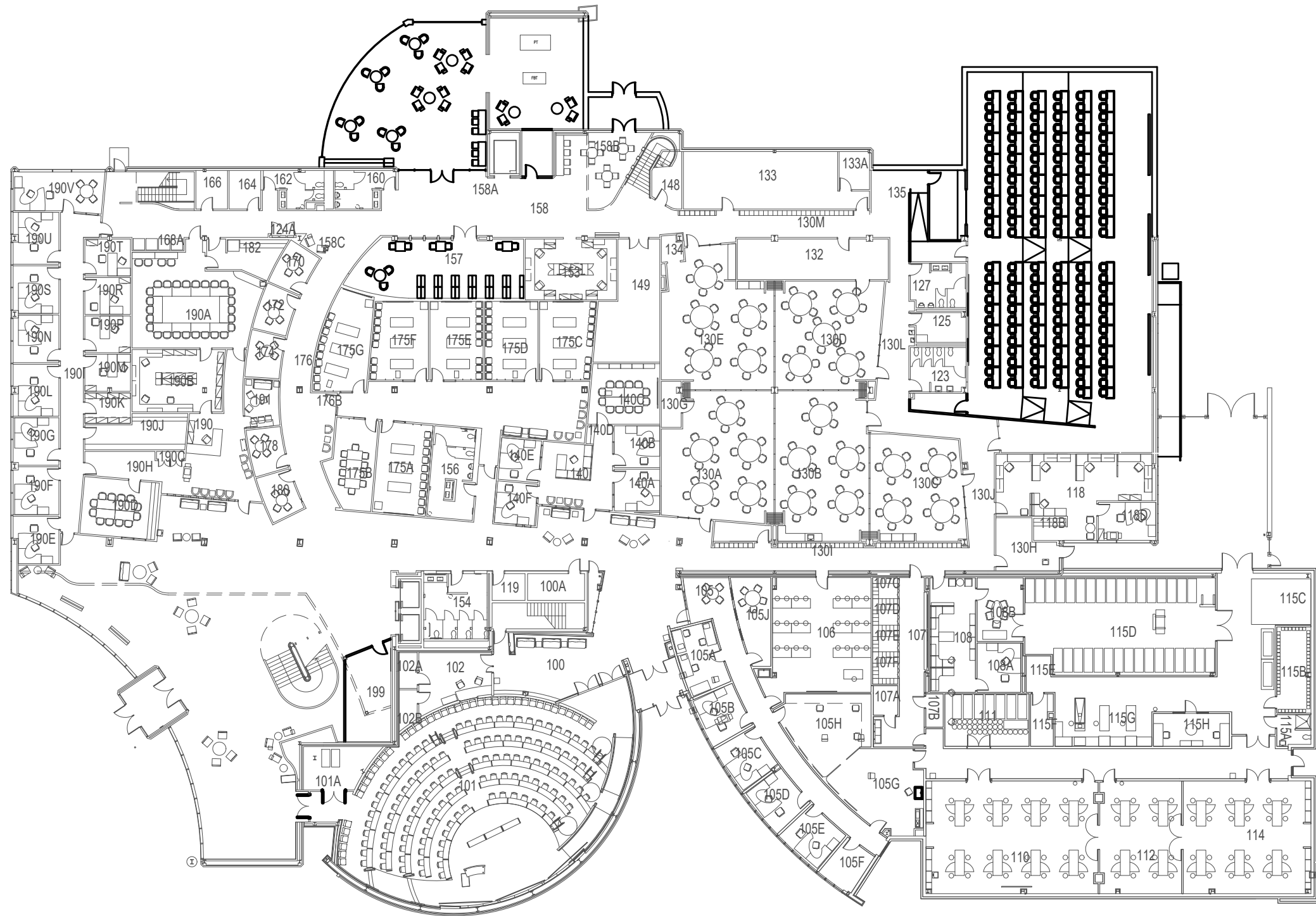

NEW CONSTRUCTION PLAN - SECOND FLOOR

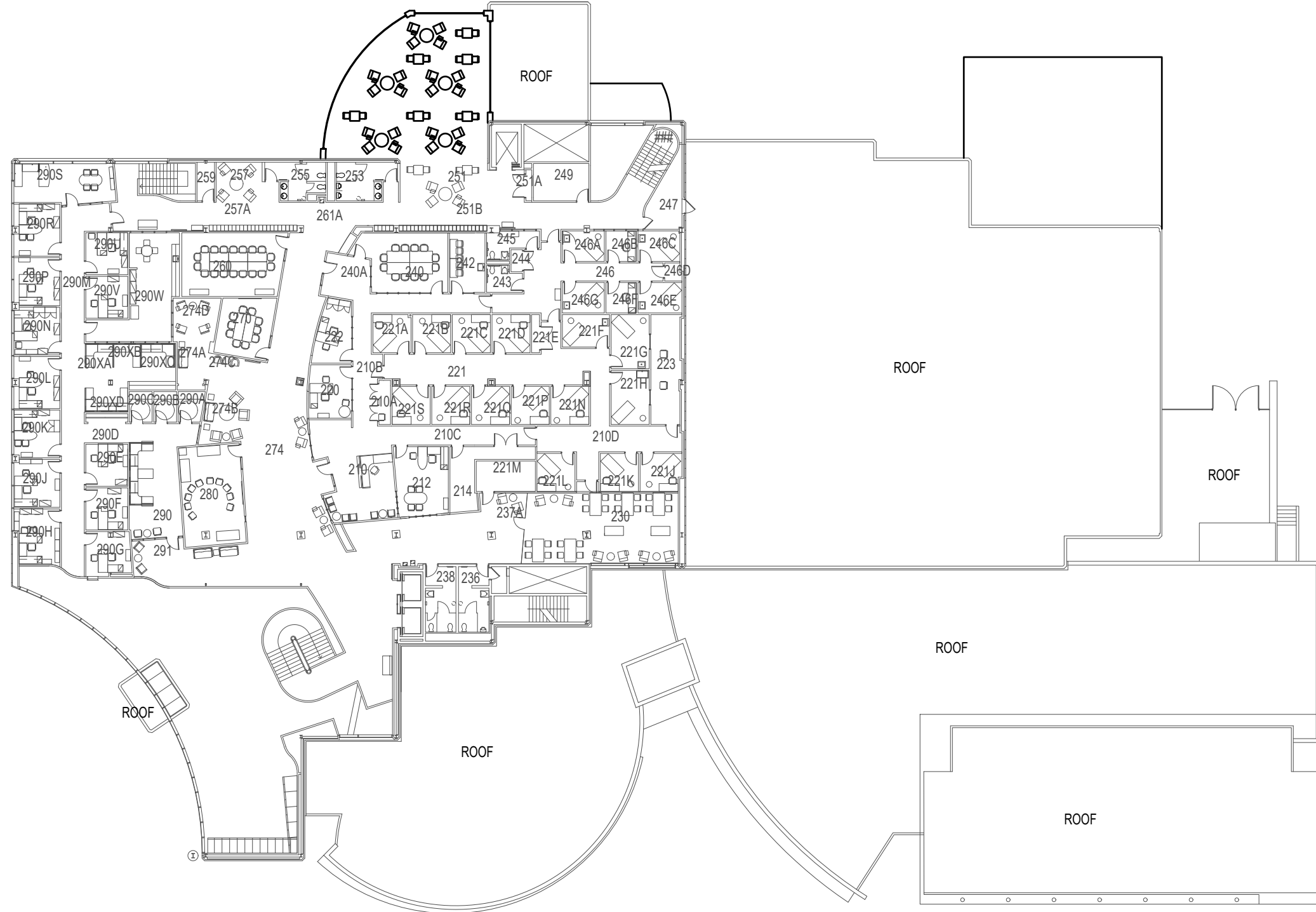



Deborah A. Feldman
President and CEO
Executive Office

October 20, 2021

TO WHO IT MAY CONCERN:

I am writing in support of the Wright State University's Boonshoft School of Medicines (BSOM) proposal for our region. They are seeking matching funds in the amount of \$1.25 million to add educational space onto the White Hall medical education building which is on WSU's campus in Fairborn. BSOM will be self-funding the other half as the total project cost is \$2.5 million.

This project is necessary for BSOM to increase its enrollment from approximately 120 students a year to 150 students per year over the next five years. It will include larger classrooms to accommodate learning needs, as well as additional space for study and student life.

This project addresses the critical physician workforce shortage that the United States is experiencing; current estimates are that the US physician workforce shortage will be as much as 124,000 by 2034. In response to this, the Association of American Medical Colleges has called for US medical schools to increase enrollment. BSOM's mission is to produce physicians to meet the needs of the Ohio and the Miami Valley along with our strong track record of training outstanding doctors compels us to answer this call. Given that half of our graduates remain in Ohio and locally, this project will have a sustained impact on medical care outcomes in our region and a significant economic downstream benefit.

Please let me know if you require any further information on this request. Wright State University BSOM and Dayton Children's have been strong partners and we wholeheartedly support this request for funding.

Respectfully,

Deborah A. Feldman
President and CEO



Montgomery County Medical Society

October 27, 2021

Valerie Weber, M.D
Dean and Professor of Medicine
Boonshoft School of Medicine, WSU
3640 Colonel Glenn Highway
Dayton OH 45435

Dear Doctor Weber:

The Montgomery County Medical Society (MCMS) appreciates learning that the WSU Boonshoft School of Medicine is filing an application to the Dayton Region Priority Development and Advocacy Committee for consideration of its plans to add educational space to its campus to permit an increase in medical student enrollment. This additional growth potential for training future physicians is critical to addressing the workforce supply shortage that is facing our nation and specifically our local region.

MCMS has been a supportive partner of the Wright State University School of Medicine since its founding in 1973. Many former MCMS physician leaders were instrumental in helping to secure the foundation for this community based medical school, and we continue to value the relationships that BSOM has established with practicing physicians to enhance the medical training experience for its students.

The Boonshoft School of Medicine has an impressive record of graduates who remain to practice in Ohio and our local communities. MCMS is honored to offer support of the effort to increase medical school enrollment in order to continue its mission to produce the requisite number of physicians needed to serve our patients now and into the future.

Sincerely,

A handwritten signature in cursive script, appearing to read "David O. Griffith".

David O. Griffith, M.D.
President

*Montgomery County Medical Society • 5335 Far Hills Avenue Ste 217 • Dayton OH 45429
Voice (937) 223-0990 • Fax (937) 223-6363*



October 26, 2021

Valerie Weber, MD, MS
Dean
Professor of Medicine
Boonshoft School of Medicine
Wright State University
3640 Colonel Glenn Highway
Dayton, OH 45435

Dear Dr. Weber,

I am writing on behalf of Premier Health in support of your application for funding in the current PDAC process. Your proposal to add space to the White Hall medical education building at the Boonshoft School of Medicine is one that will have a lasting impact on our entire community. The increasing need for physicians locally, combined with shortages on a national basis is something we all need to support. We believe it is necessary to enable us to continue to provide the best possible healthcare services to our patients.

The goal to increase the number of medical students is critical as the Boonshoft School of Medicine continues to be a pipeline to recruit the next generation of physicians for Premier Health and throughout the state of Ohio. We support this proposal and ask that those reviewing the requests include this in the funding recommendations for approval.

Sincerely,

A handwritten signature in black ink that reads "Mary Boosalis".

Mary Boosalis
President & CEO



Executive Offices
3965 Southern Boulevard
Kettering, OH 45429
(937) 395-8366
ketteringhealth.org

November 2, 2021

Dear Dayton Region Priority Development and Advisory Committee,

I am writing on behalf of Kettering Health System to express support for the project entitled "Expansion of the Medical Education Building at Wright State University/Boonshoft School of Medicine."

As you know, the Boonshoft School of Medicine, since its founding over 40 years ago, has provided a steady stream of outstanding physicians to serve the Miami Valley region. Answering the present and projected physician workforce shortage, the leadership at WSU/BSOM has plans to expand enrollment at BSOM over the next 3-5 years. This expansion will ensure the outstanding medical care environment that our region enjoys. The project will lead to many downstream economic benefits from adding additional physicians and other supporting personnel (faculty, student support personnel) into our region, as well. WSU/BSOM will provide self-funding for half of the expenses of the project, as outlined in the proposal.

We endorse this project, as it responds to the critical need for the healthcare workforce and will ensure positive health care outcomes in our region for decades to come.

Thank you,

A handwritten signature in blue ink, appearing to read "T Burns".

Terry Burns
Executive Vice President and
Chief Administrative Officer

Access Hospital Dayton

Atrium Medical Center

Dayton Children's Hospital

Dayton Veterans Affairs
Medical Center

Encompass Health
Rehabilitation Hospital of
Dayton

Grand Lake Health System

Haven Behavioral Hospital

Indu and Raj Soin Medical
Center

Kettering Health Behavioral
Medical Center

Kettering Health Dayton

Kettering Health Greene
Memorial

Kettering Health Hamilton

Kettering Health Main Campus

Kettering Health Miamisburg

Kettering Health Troy

Kettering Health Washington
Township

Kindred Hospital Dayton

Mercy Health – Springfield
Regional Medical Center

Mercy Health – Urbana
Hospital

Miami Valley Hospital

Miami Valley Hospital North

Miami Valley Hospital South

PAM Specialty Hospital of
Dayton

Upper Valley Medical Center

Wayne HealthCare

Wilson Health

Wright Patterson Medical
Center

NOVEMBER 4, 2021

DAYTON DEVELOPMENT COALITION

1401 S. MAIN ST., STE. 200

DAYTON, OH 45409

RE: Wright State University Boonshoft School of Medicine White Hall Medical Education Building

Dear Hospitals, Health Care, and Human Services Committee Members:

On behalf of the Greater Dayton Area Hospital Association (GDAHA), I am pleased to submit this letter of support on behalf of Wright State University Boonshoft School of Medicine's (WSU-BSOM) questionnaire for the Dayton Region Priority Development and Advocacy Committee (PDAC). This strategic investment in our region's health education infrastructure will have a positive impact on the future of our healthcare workforce.

WSU-BSOM seeks matching funds in the amount of \$1.25M to increase the educational space of the White Hall medical education building on Wright State University's Fairborn campus. The increase in physical infrastructure is necessary to increase enrollment by 25 percent over the next five years which will help the region address current and future physician workforce shortages. WSU-BSOM's mission to produce physicians to meet the needs of the Ohio and the Miami Valley, along with their strong track record of training outstanding doctors, ensures that this will be a solid investment in the overall health and wellbeing of the Dayton region. Given that half of WSU-BSOM's graduates remain in Ohio and locally, this project will have a sustained impact on medical care outcomes in our region and a significant economic impact. WSU-BSOM will self-fund the remaining project cost of \$2.5M.

GDAHA's 29 hospitals and health systems serve the healthcare needs of citizens across 11 counties in the Dayton region. Well-trained, quality physicians are critical to their mission and service to the community. As such, we view WSU-BSOM as an integral component to educating our future healthcare workforce and ensuring we have the resources necessary to support the region's healthcare delivery system.

I support Wright State University and the Boonshoft School of Medicine's commitment to improve the health of our community and consider this project a worthwhile investment in the Dayton area.

Sincerely,



Sarah Hackenbracht
President & CEO

November 4, 2021

Valerie Weber, M.D.
Dean and Professor of Medicine
Boonshoft School of Medicine
3640 Colonel Glenn Highway
Dayton, OH 45435

Dear Dr. Weber:

The Greene County Board of Commissioners fully supports the proposed Expansion of the Medical Education Building (White Hall) at the Boonshoft School of Medicine as it is a vital part of maintaining quality public health of the region.

The Boonshoft School of Medicine has a history of educating countless physicians that serve the citizens of Greene County over the past 41 years. With the expansion of the Medical Education Building, the Boonshoft School of Medicine will increase the class size to approximately 150 students, many of which will serve the region throughout their careers. This expansion will come with opportunities for increased training capabilities for medical students, residents, and first responders.

As we continue to combat against a global pandemic, we are reminded that key investments must be made in medical education to ensure access to quality medicine is never interrupted.

The Greene County Board of Commissioners fully supports the Boonshoft School of Medicine in its mission to increase the amount of practicing physicians in the region.

Thank you.

Sincerely,

THE GREENE COUNTY BOARD OF COMMISSIONERS



Richard D. Gould, President



Tom Koogler, Vice President



Rick Perales, Commissioner

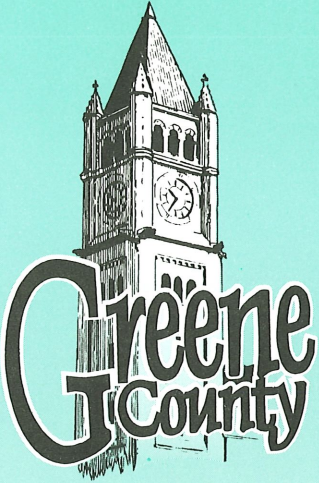

Board of Commissioners

Richard D. Gould, CPA
Tom Koogler
Richard G. Perales

35 Greene Street
Xenia, Ohio 45385-3101

Phone: (937) 562-5006
Fax: (937) 562-5331
Administrator: (937) 562-5002
Clerk: (937) 562-5165
www.greencountyohio.gov

Columbus Office

Vern Riffe Center
77 S. High Street
13th Floor
Columbus, Ohio 43215-6111

(614) 644-6020
Rep73@ohiohouse.gov
www.ohiohouse.gov



Committees

Insurance, Vice-Chair
Armed Services & Veterans Affairs
Financial Institutions
Civil Justice

73rd House District
Greene County (western)

Representative Brian Lampton

November 5, 2021

The Honorable Mike DeWine
Governor
State of Ohio
77 S. High Street-30th Floor
Columbus, OH 43215

Governor DeWine:

I want to express support for the Boonshoft School of Medicine at Wright State University as they seek support to expand their class capacity and programs. Born from a vision of a community-based medical school in the Miami Valley, the school has grown significantly from its first class of 32 students to 120 physicians in 2021. The Boonshoft School of Medicine's mission has grown significantly to include graduate medical education, clinical care, and research.

Current estimates project continued physician workforce shortages for the next decade in the range of 30,000 to 100,000 nationally. To respond to this need, the Boonshoft School of Medicine seeks to expand their class size for the entering class in July 2021 to 130. In order to accommodate the learning needs of the increased number of students in their innovative curriculum, the need for capital improvements to White Hall is needed. Currently, their largest class room can only hold approximately 130 students.

Along with the enlarged space, they are planning additional staff to handle the enlarged class size, and to ensure a successful national accreditation visit in 2025. Over the next five years, this will allow their total MD enrollment to expand from approximately 480 to approximately 600.

Additionally, they are supportive of training first responders and would have available classroom space to use for these trainings. They currently have a simulation center with outdated equipment and limited space. Expansion would allow them to be a regional center to include pipeline programs for high school students, regional first responders, and nursing.

www.house.state.oh.us
77 S. High Street, Columbus, Ohio 43215-6111

"With God All Things Are Possible" – Motto of the Great State of Ohio

Columbus Office

Vern Riffe Center
77 S. High Street
13th Floor
Columbus, Ohio 43215-6111

(614) 644-6020
Rep73@ohiohouse.gov
www.ohiohouse.gov



Committees

Insurance, Vice-Chair
Armed Services & Veterans Affairs
Financial Institutions
Civil Justice

73rd House District
Greene County (western)

Representative Brian Lampton

My legislative aide, Michael Graham, will serve as the primary point of contact for our office and looks forward to continuing to work with Wright State University in this endeavour. Our region has long benefitted from the success of our academic and research institutions. As our region looks to stay globally competitive, it is imperative that we support the next generation of medical professionals in the Miami Valley.

Sincerely,

A handwritten signature in blue ink, appearing to read "B. Lampton", with a long horizontal flourish extending to the right.

Brian Lampton
State Representative

www.house.state.oh.us
77 S. High Street, Columbus, Ohio 43215-6111

“With God All Things Are Possible” – Motto of the Great State of Ohio